

# ELECTRONIC LOCKING SYSTEM

## ELECTRONIC CABINET LOCK

3211



### Touch Panel



Electronic solutions for improving security

#### APPLICATIONS:

Various cabinets or lockers in sauna area, spa, gym, office, school, etc.



#### Technical specifications

- Ability to open with a password without card and key
- Elegant design suitable for office environments
- When the password has been forgotten, it is possible to remote control and USB-Key for solving the password
- Micro USB emergency power-supply
- Low battery level indicator
- For general or specialised use
- Auto-alarm will be activated when input wrong password 4 times and the lock will be died for 60 seconds.
- You can create the fake pin password against thievery
- Easy installation
- Easy to use
- High-security
- Melody yes/no adjustment
- Stylish visual-warning LEDs

- Operating voltage: 2x1.5 V = 3 V
- Battery: 2xAAA Alkali battery
- Battery life: Approx. 1.5 year ( daily 10 use )
- Password combination: 1-15 digit
- Operating temperature range: -20°C ~ +70°C
- Operating humidity range: 0 ~ 90 % RH

#### MATERIALS

BODY: Aluminium  
HANDLE: Aluminium  
CAM: Steel

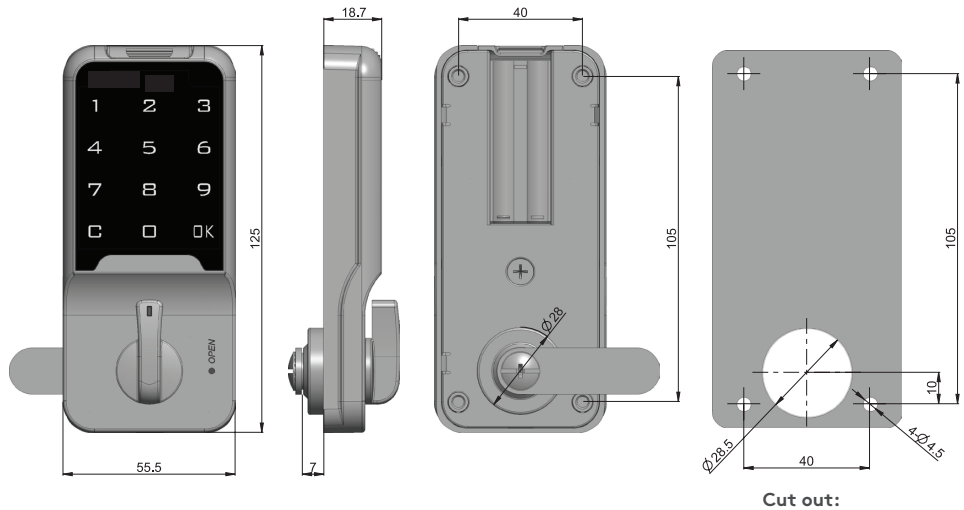

Battery box

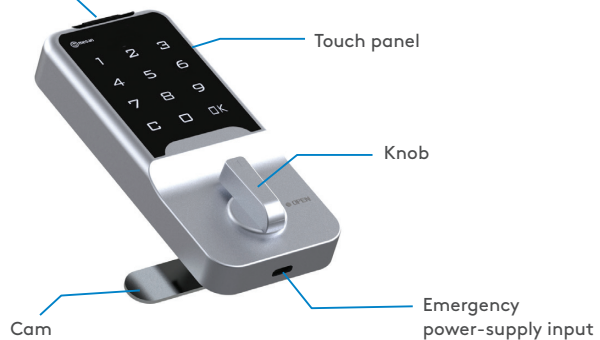

#### PRODUCT CODE

3211 - CC  
GROUP CODE CAM

For cams please check page: 175 (Cam 1)